

Gigabit SFP Optical Module

Plug-in Mounting

Industrial Single/Multi-Mode Single/Double Fiber 100M SFP Optical Module

- Transmission speed 1.25Gb/s
- Support LC optical fiber connector and hot-plug
- Support Digital Diagnosis Monitoring (DDM) function, conform to SFF-8472 standard, which can monitor parameters such as module voltage, temperature, bias current and optical power
- Work voltage 3.3V
- Support -40~85°C wide operating temperature range



Industrial Grade

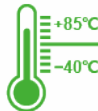

Introduction

This series of products is industrial Gigabit SFP optical module, which implements photoelectric conversion in optical network and is used with Gigabit SFP slot of Ethernet communication device. Optical module supports DDM (digital diagnosis and monitoring) function, and can monitor module voltage, temperature, bias current or optical power and other parameters in network management devices with DDM function for network diagnosis. This series of products can be selected according to different optical fiber types, transmission distances and transmission wavelengths, and can support hot plug and meet the needs of different application sites.

Dimension

Unit: mm

- Single-mode single-fiber

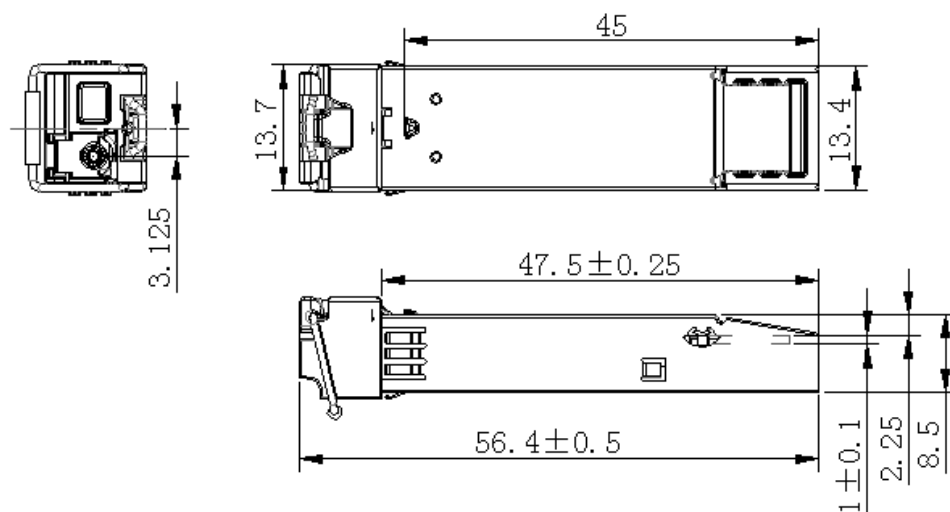

- Single/multi-mode double-fiber

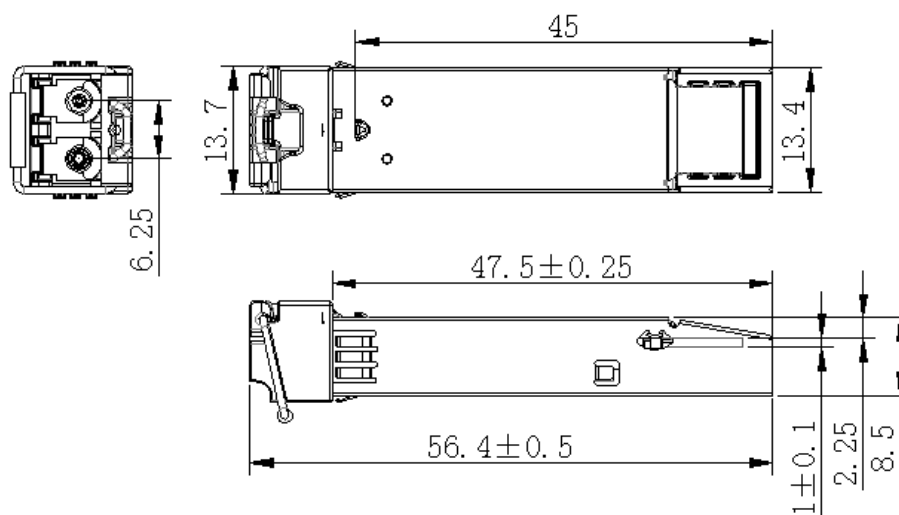

Note:

- This is the dimension of the shell, excluding the handle and skirt parts.
- The unmarked dimension tolerance is $\pm 0.2\text{mm}$.

Specification

Interface	Interface type: LC Transmission speed: 1.25Gb/s Transmission distance: multi-mode double-fiber 1310nm, 2 km; Single-mode double-fiber 1310nm, 1550nm, 20/40/80 km; Single-mode single-fiber 1310/1550nm, 20/40/60/80km Support DDM (Digital Diagnosis Monitoring) function
Working Environment	Operating temperature: $-40\sim 85^{\circ}\text{C}$ Storage temperature: $-40\sim 85^{\circ}\text{C}$ Relative humidity: 5%~95% (no condensation)
Physical Characteristic	Shell: metal shell Installation: plug-in mounting
Authentication	CE, FDA, C-TICK, RoHS
Warranty	1 year

Ordering Information

Available Models	Optical Fiber Type	Transmission Speed	Interface Type	Core Wavelength (nm)	Transmission Distance (km)	Work Temperature (°C)	DDM	Tx Optical Power (dBm)	Max Receiving Sensitivity (dBm)
SW2825DI-142	MM	1.25G	LC	1310	2	-40~85	√	-9~-3	-20
SW3825DI-442	SM	1.25G	LC	1310	20	-40~85	√	-6~-1	-21
SW3825DI-542	SM	1.25G	LC	1310	40	-40~85	√	-2~3	-24
SW4825DI-742	SM	1.25G	LC	1550	80	-40~85	√	-3~-2	-26
SWB3825DI-442	SS	1.25G	LC	1310T/1550R	20	-40~85	√	-9~-1	-23
SWB4825DI-442	SS	1.25G	LC	1550T/1310R	20	-40~85	√	-9~-1	-23
SWB5825DI-542	SS	1.25G	LC	1490T/1550R	40	-40~85	√	-7~-1	-24
SWB4825DI-542	SS	1.25G	LC	1550T/1490R	40	-40~85	√	-7~-1	-24
SWB5825DI-642	SS	1.25G	LC	1490T/1550R	60	-40~85	√	-5~0	-24
SWB4825DI-642	SS	1.25G	LC	1550T/1490R	60	-40~85	√	-5~0	-24
SWB5825DI-742	SS	1.25G	LC	1490T/1550R	80	-40~85	√	-3~-2	-26
SWB4825DI-742	SS	1.25G	LC	1550T/1490R	80	-40~85	√	-3~-2	-26

Note:

- Type of optical fiber: MM is multi-mode double-fiber, SM is single-mode double-fiber and SS is single-mode single -fiber.
- Generally, optical modules should be used in pairs, and the type, speed, wavelength and distance of optical fibers should match. The transmission and receiving wavelengths of single-mode single-fiber are different, for example, 1310T/1550R and 1550T/1310R need to be used in pairs.



Address: 3/B, Zone 1, Baiwangxin High Technology Industrial Park, Song Bai Road, Nanshan District, Shenzhen, 518108, China

TEL.: +86-755-26702668 ext 835 FAX: +86-755-26703485

E-mail: ics@3onedata.com

Website: www.3onedata.com

◀ Please scan our QR code for more details

*Product pictures and technical data in this datasheet are only for reference. Updates are subject to change without prior notice. The final interpretation right is reserved by 3onedata.